

How To Install Your Walking Foot

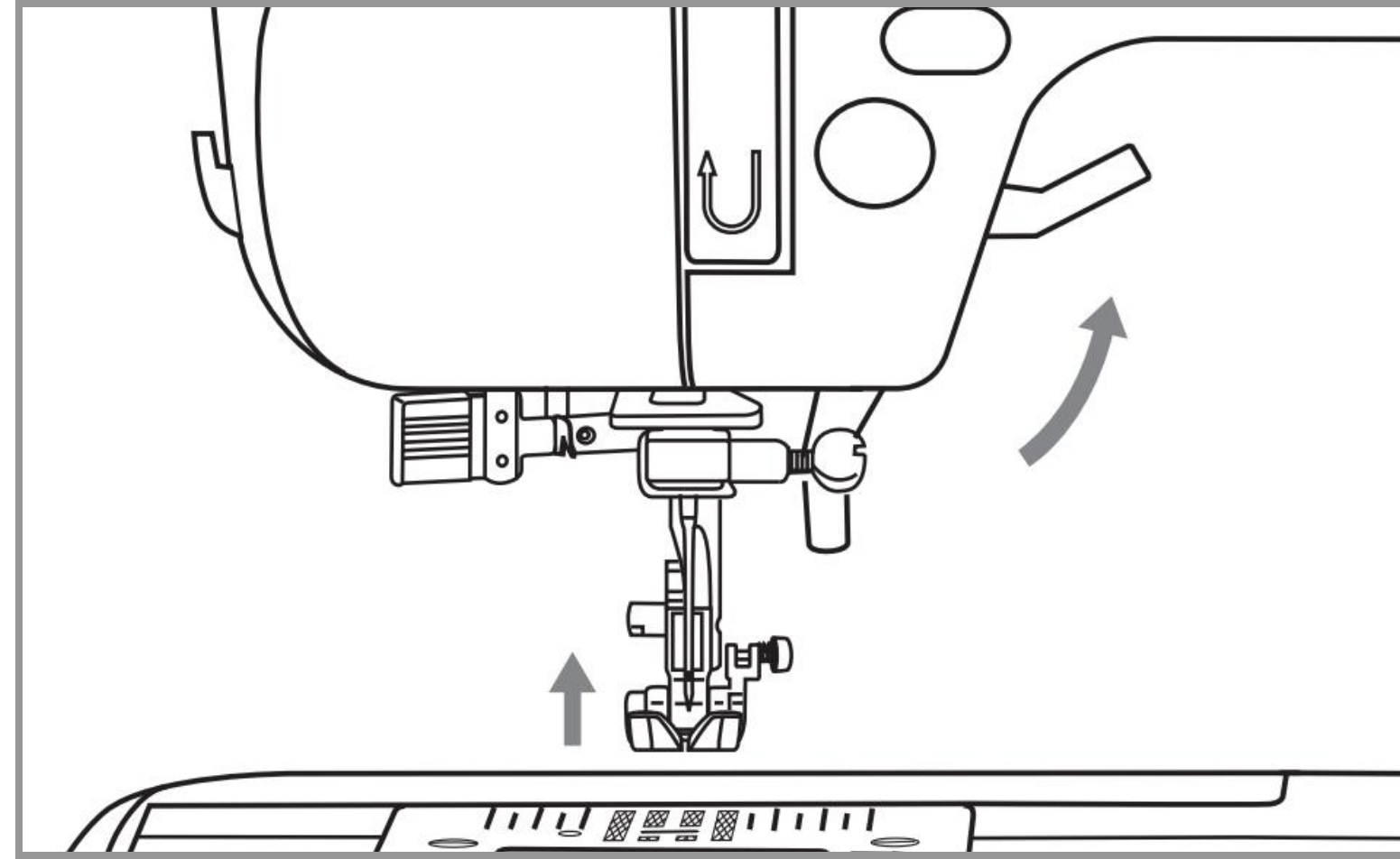

Step One

This method applies to all screw-on feet.

First, switched off your machine. Now raise your presser foot.

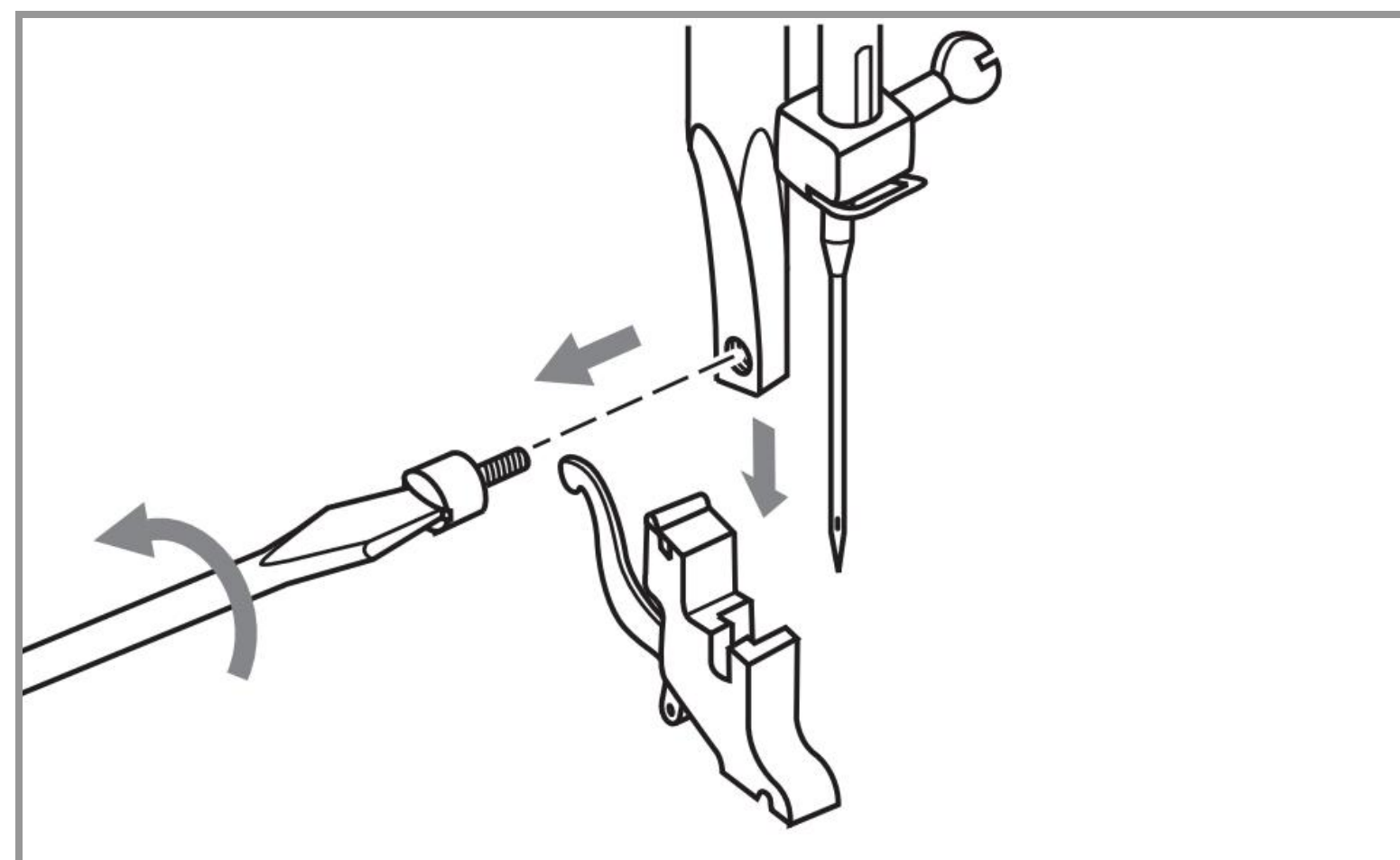

Step Two

Undo the thumb screw to remove your foot adapter (i.e. the ankle).

Don't lose the screw - you'll need it in a minute.

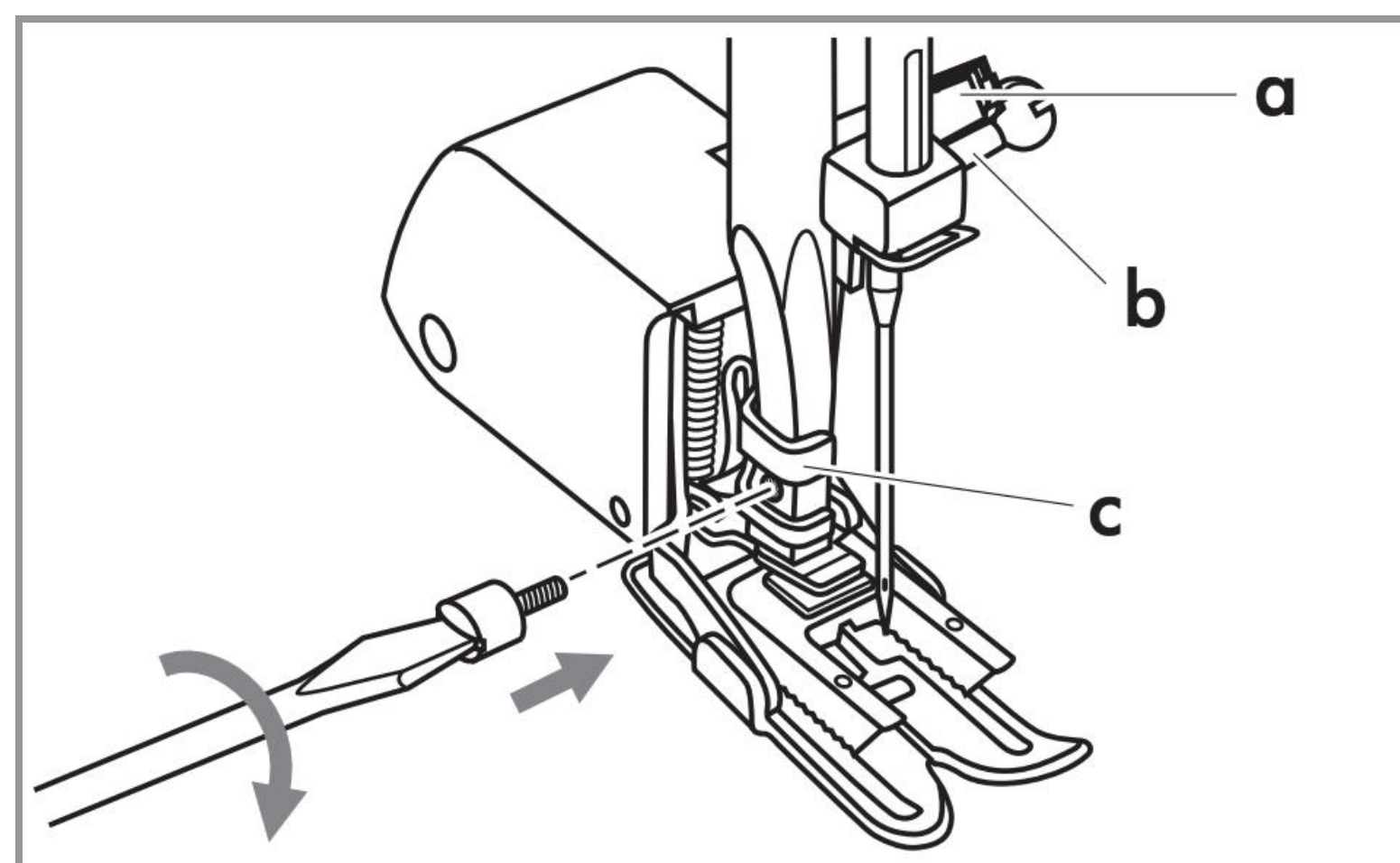

Step Three

Put the arm lever (a) of the foot on the needle clamp (b).

Tighten the screw with the prongs (c) on either side, securing the walking foot in place.

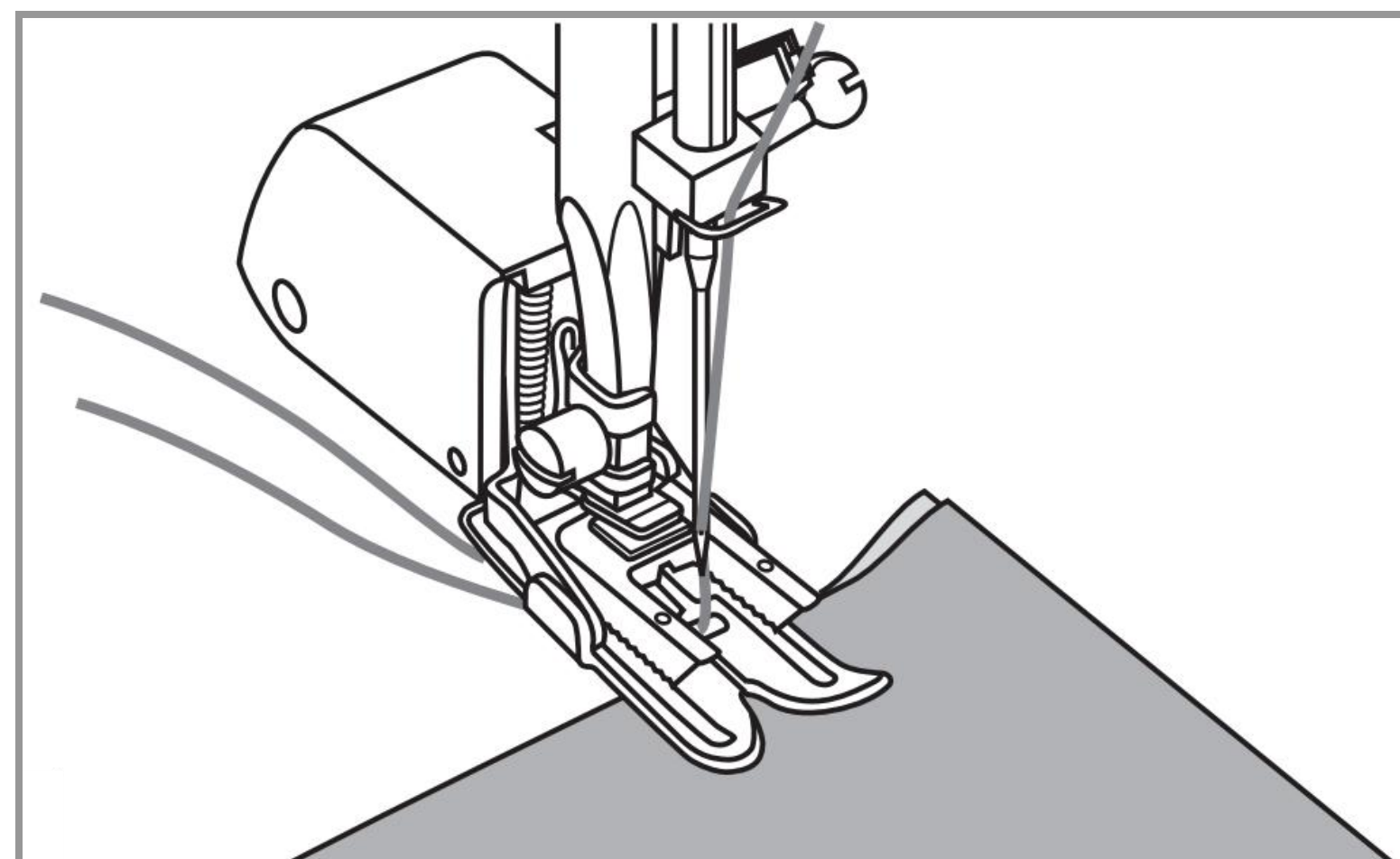

Step Four

Draw your bobbin thread up and get both the bobbin thread & the needle thread out of the way behind the foot.

You're ready to sew now!

● **SUPERIOR QUALITY GUARANTEED** ●

Custom Crafted

With utmost care and attention to ensure long-lasting sewing enjoyment for you. Proudly brought to you by the trusted team authorised by Janome in Taiwan.

**FITS
MOST
MODELS**

● **SME-217AU** ● **Made in Taiwan** ●

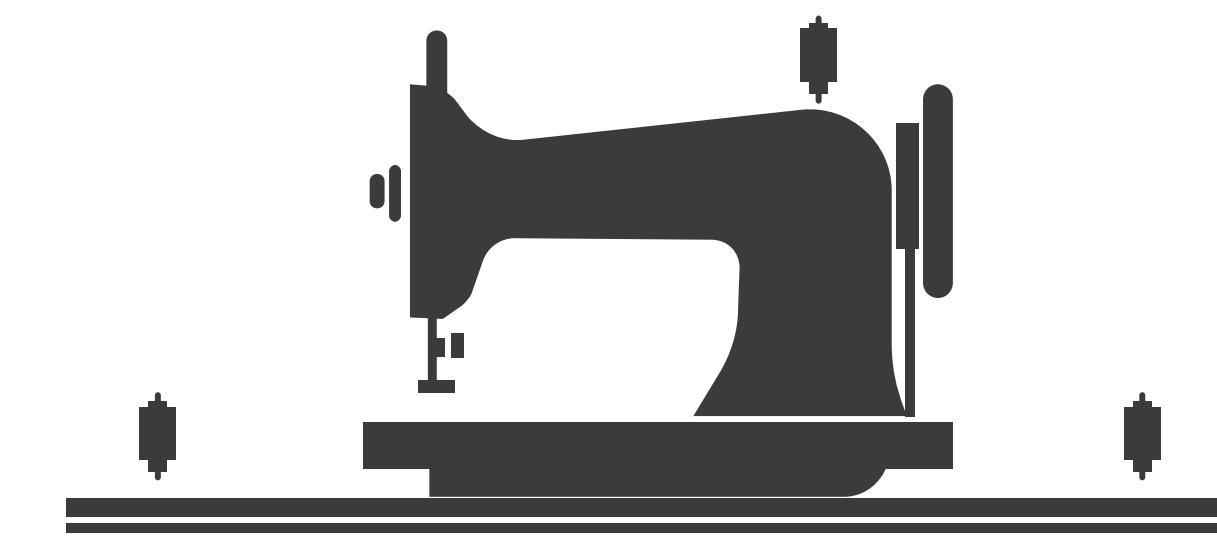

TREADLE SMITH
UNIVERSAL



The Ultimate Presser Feet Set

Designed To Fit Low Shank 7mm Machines

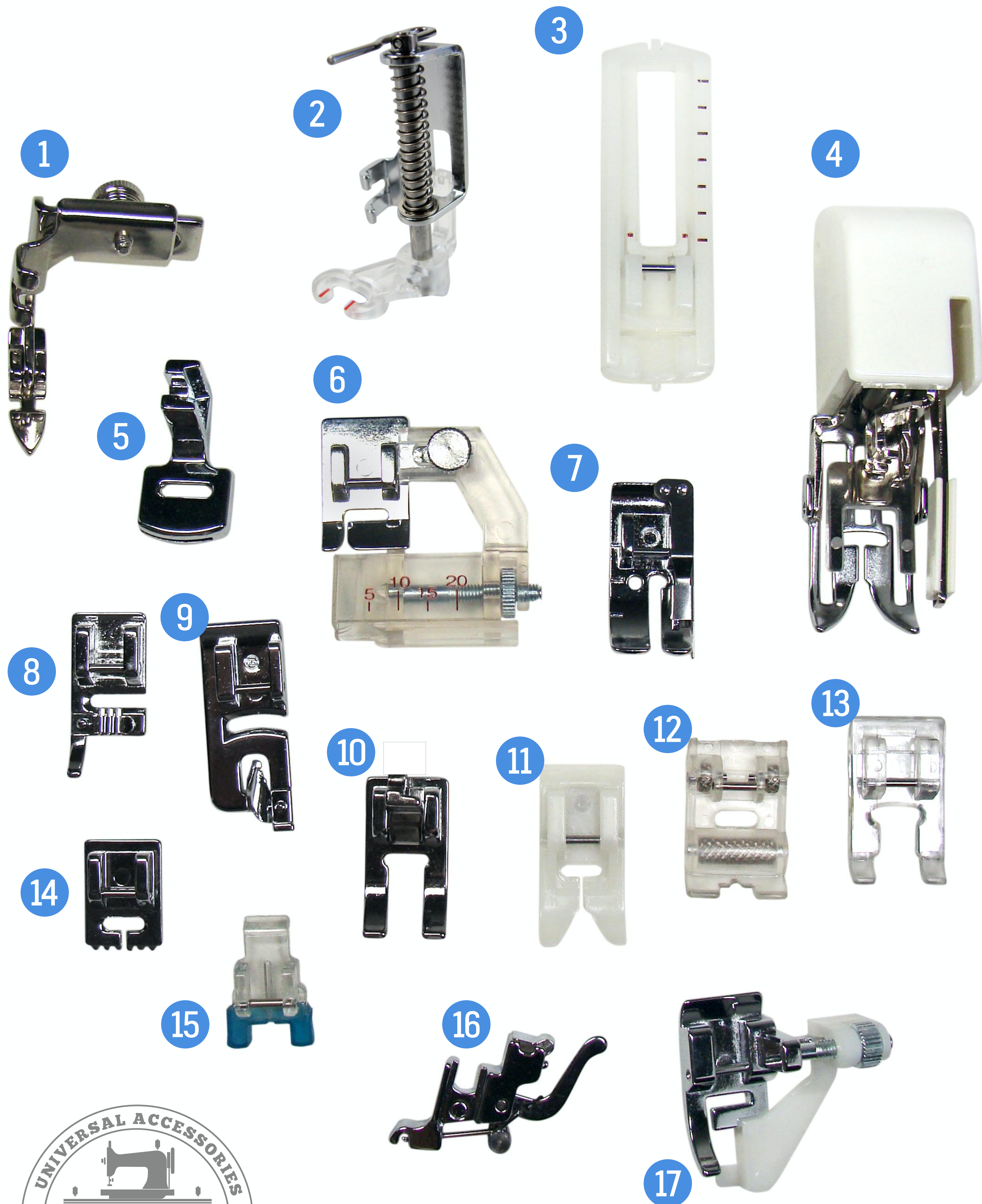

1. Super Slim Zipper Foot

The slim shape and size of this foot makes it easier for inserting (both regular & concealed) zips, and great for pipings / trims. Fully adjustable so you can get REALLY close to the zipper teeth or piping cord.

2. Freemotion Open-Toe Darning Foot

Used more for quilting than darning, this foot is spring-loaded to bounce as you "drive" the stitches freehand - forming a meandering pattern often known as "stippling". Open-toe gives better visibility.

3. Sliding Buttonhole Foot

This is a 4-Step Buttonhole Foot. The grips on the underside help feed your fabric and the sliding frame guides the fabric while the buttonhole is being stitched.

4. Even Feed Walking Foot

A walking foot feeds the fabric layers through in sync with the feed dog - this is essential for quilting because it eliminates puckering when you stitch multiple layers together. Also very useful for matching patterns like checks, stripes and plaids.

5. Gathering Foot

Use this foot to create soft gathers in light-weight fabric. You can also attach the gathered edge to a flat (ungathered) fabric at the same time - quickly and easily.

6. Adjustable Binding Foot

Simply insert folded bindings / bias tapes into the slot of the foot and you can bind the edge of your fabric stitching ONCE - without excessive pinning. Use the dials to adjust the slot to suit various binding width.

7. Quarter Inch 1/4" Foot

Also known as a "Patchwork Foot", this quarter inch foot has a built-in guide that keeps your seam at a consistent, accurate seam allowance that is exactly 1/4 inch (or 6.3mm)... no matter how fast you sew!

8. Cording Foot

For easy embellishment, simply insert cords into the 3 slots and stitch them in place with zigzag or other decorative stitches for raised textural effects.

9. Narrow Rolled Hem Foot

This foot will give your projects a bespoke finish, by creating beautiful narrow rolled hems on the edges of lightweight fabric, typically found on silk scarves.

10. Open-Toe Applique Foot

Perfect for applique, the bottom of the foot has a rectangular shaped indentation, which allows even satin / blanket stitching to glide under the foot without dragging.

11. Ultra-Glide Teflon Foot

This foot is designed to prevent fabrics such as leather and vinyl / oil-cloth, plastic, suedes and ultrasuede from sticking as you sew. The Teflon coating of this foot makes it glide over difficult fabrics.

12. Roller Foot

Excellent for denim, this foot rolls over heavy seams and uneven surfaces. preventing difficult or heavy fabric from slipping or jamming under the foot.

13. Clear Zigzag Foot (Open-Toe)

Also known as "custom craft foot", this foot is perfect for applique, embroidery, cutwork and monogramming. Being clear & open-toe allows best visibility

14. Pin Tuck Foot

Use twin needles with this foot to create small tucks for effortless heirloom sewing. The grooves under the foot accommodate parallel rows of pintucks in lightweight fabrics

15. Button Sewing Foot

To sew buttons by machine, simply choose a zigzag stitch width that matches the distance between the holes on your button, and lower (or cover) your feed dog before sewing.

16. Low Shank Foot Adapter

This is the "ankle" that snaps your feet on and off. Keep this handy in case you lose the one on your machine!

17. Adjustable Blind Hem Foot

You can produce invisible hems fast - simply by using the blind hem stitch on your sewing machine. This foot gives you a professional finish and saves your alteration bills!

Custom Crafted to Japanese Quality. For Your Sewing Enjoyment.